

# **JOHNSON PREMIUM HARDWOOD FLOORS**

## **OCEANFRONT VINYL PLANK FLOORING INSTALLATION**

### **GUIDELINES**

12/12/16

#### **READ BEFORE INSTALLING**

Oceanfront Vinyl Plank flooring is designed to replicate the look of a real wood floor. Our intention is to include variations in surface texture, color, grain patterns, and gloss levels. To make the floor look as realistic as possible, we recommend working from several cartons at once for a natural look.

The installer and/or end user is responsible to inspect the Oceanfront floor before installing the planks. If a plank is questionable in terms of color, pattern, texture, gloss level, or milling, do not install it. Johnson cannot be responsible once the plank is installed.

Due to the precise milling of the tongue and groove clic system, subfloor flatness needs to be within 3/16" in a 10' radius for best product performance. Johnson also recommends maintaining a ¼" expansion space along both edges and ends of the boards and between any walls or vertical obstructions. And while our Oceanfront floor is waterproof, it is not a proper moisture barrier. Proper waterproofing practices should be followed to protect the home from moisture issues.

#### **PREINSTALLATION JOBSITE CHECKLIST**

- Jobsite conditions are beyond the control and responsibility of Johnson Hardwood.
- Inspect each piece before installing and do not install any questionable/objectionable pieces.
- Crawl spaces below Oceanfront flooring must be properly ventilated and covered with black polyethylene film.
- Room temperature in the home, before, during, and after installation needs to be consistent with normal living conditions. (approximately 65-75 degrees and 30 to 50% humidity levels)
- Vinyl flooring can be susceptible to thermal degradation if subjected to long periods of direct exposure to excessive heat and sunlight. Use of shades/blinds/drapes, or other window treatments is suggested to avoid exposing the floor to extreme sunlight conditions.

#### **SUBFLOOR REQUIREMENTS**

- Subfloor must be clean, structurally sound/tight, and visibly dry.
- Floor must be flat to within a 3/16" in 10' radius tolerance.
- Acceptable Substrates include: Concrete Slab, Sheet Vinyl, Ceramic Tile, CDX Grade Plywood, OSB (3/4" Min), Underlayment grade Particleboard, and existing Hardwood or Laminate floors.

**RADIANT HEAT:** Oceanfront is approved for over in-floor radiant heat systems. The following guidelines apply:

- The heating system should be turned off during the installation, as well as 24 hours before, and 24 hours after.
- After installation, the system should gradually be brought up to temperature, and should never exceed 85 degrees.
- Surface applied heating mats are not an acceptable type of radiant heat.

### **BEFORE INSTALLING YOUR FLOOR**

- Plan your layout to allow for a ¼" expansion space from all vertical obstructions
- Dry lay several cartons of flooring to get a feel for color and surface variations and to make sure the floor meets the end users satisfaction. Claims for color, surface, and grain variations cannot be accepted once the floor is installed.
- If color coordinated molding is to be used, first select Oceanfront panels that best match the available molding and make sure these panels are installed adjacent to the molding.

### **FLOOR INSTALLATION**

- Carefully follow the installation graphics and printed instructions below each picture.
- Take precautions with tapping blocks and pull bars so that the Unilin Angle/Tap tongue and groove system is not damaged.
- Johnson Silent Seal Premium Underlayment may be used for added sound deadening and moisture control.
- If you have any questions before or while installing the floor, call Johnson Hardwood technical Service Department @ 800/910-3047.

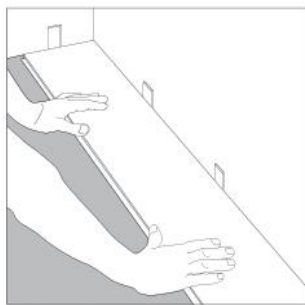

**Step 1:** Begin installation working from left to right. Insert 1/4" wide spacers at ends and edges where planks meet wall.

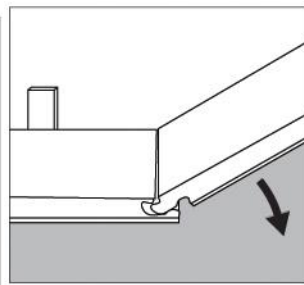

**Step 2:** Lock short end of plank by inserting tongue into groove at an approximate 30 degree angle and drop into place. Continue this process throughout the installation.

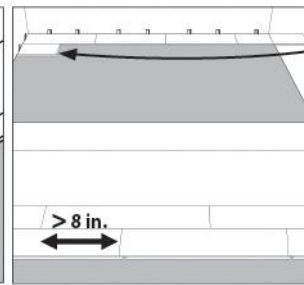

**Step 3:** Use the remaining plank from your cut piece to begin the next row (you will repeat this process throughout the installation). Note: It is recommended that you space end-joints by a minimum of 8 inches.

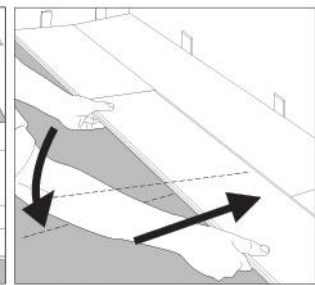

**Step 4:** Lock long edge of plank by inserting tongue into groove at an approximate 15 degree angle and drop into place. Next slide toward end of previously installed plank until the tongue touches the groove.

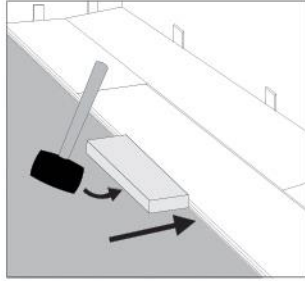

**Step 5: IMPORTANT!** Use a hammer and tapping block to tap the long edge of the plank to ensure a tight fit. Note: Tapping block should be a minimum of 10" to 12" long. It is important to note that any/all gapping can/will compromise the locking system.

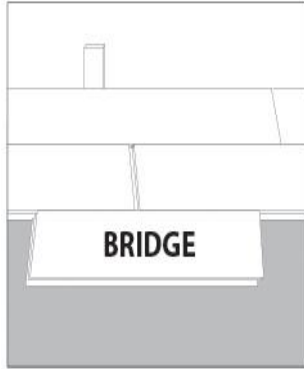

**Step 6:** Attach a scrap piece of floor to bridge gap between ends of planks.

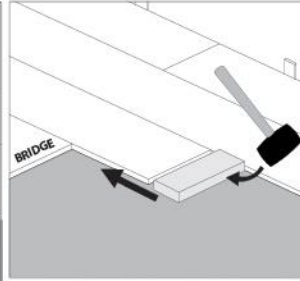

**Step 7:** Tap end of plank with hammer and tapping block to lock ends of planks together. Remove support bridge and continue with this method until you have completed installing the row. Note: **BE SURE TO TAP ON EDGE OF VINYL SO AS NOT TO DAMAGE LOCKING PROFILE.**

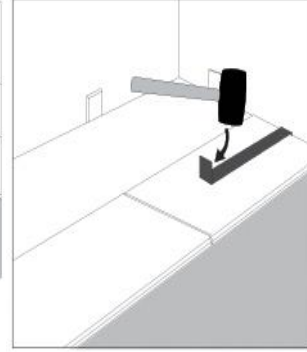

**Step 8:** Use hammer and pull bar to lock final piece in row. Insert spacer at end of row. Continue installation to final row.

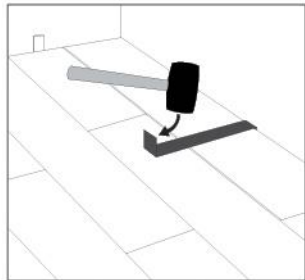

**Step 9:** Use hammer and pull bar to lock long edges of planks on final row.

### **INSTALLING UNDER DOOR JAMBS:**

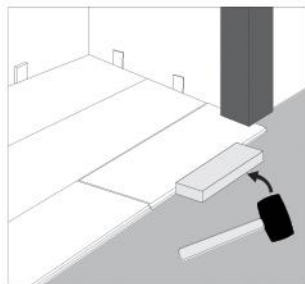

**Step 1:** Undercut door jamb to provide space to allow plank to slide freely. Tap long edge with hammer and tapping block to lock long edge.

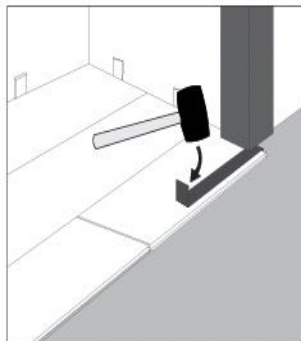

**Step 2:** Use hammer and pull bar to draw in and lock short end of plank.

## **MAINTAINING AND PROTECTING YOUR FLOOR**

- As with any fine floor covering, care should be taken when moving heavy furniture or appliances back into the room. Use wood panels to protect the floor when rolling heavy appliances back into place.
- Proper floor protectors should be used under any furniture which is regularly moved, or which is heavy and may dent the floor.
- Non staining, non-rubber backed protective mats should be used under rolling office chairs, and any rolling furniture/carts need to have wide, flat wheels.
- Protective walk off mats should be used at all exterior doors.
- Oil and petroleum based driveways can stain vinyl floors. Do not track petroleum based products onto a Oceanfront floor.
- Sweep or vacuum the floor regularly to remove dirt/grit. Do not use a vacuum with a revolving beater bar.
- Oceanfront should be regularly cleaned with a low PH cleaner such as Bona Professional Series Stone, Tile & Laminate Cleaner. Follow manufactures instruction.

*JOHNSON PREMIUM HARDWOOD FLOORS*

*825 SENTOUS AVENUE, CITY OF INDUSTRY, CA 91748 800/910-3047*